

Clutch

EFAS 17

ref: 323.600.00

Specifications

Nominal torque	1.7	N.m	<i>ft.lbf</i>	1.25
Minimal torque	0,03	N.m	<i>ft.lbf</i>	0.022
Coil resistance - 20°C			<i>W</i>	37
Rated current DC			<i>A</i>	0.57
Rotor inertia	$7.8 \cdot 10^{-6}$	kg.m ²	<i>lb.ft²</i>	$181 \cdot 10^{-4}$
Weight	0,70	kg	<i>lb</i>	1.54
Heat dissipation continuous sustained			<i>W *</i>	30

* Heat dissipation is the mechanical power ($P = c_w$) maximum allowable.

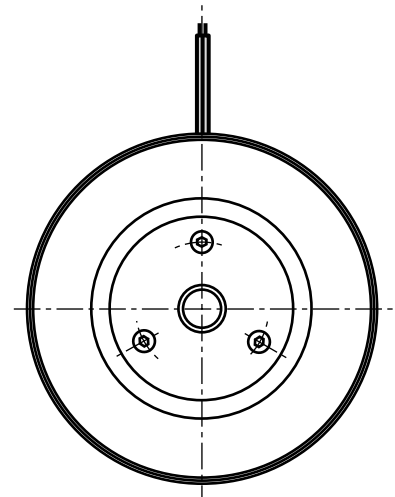
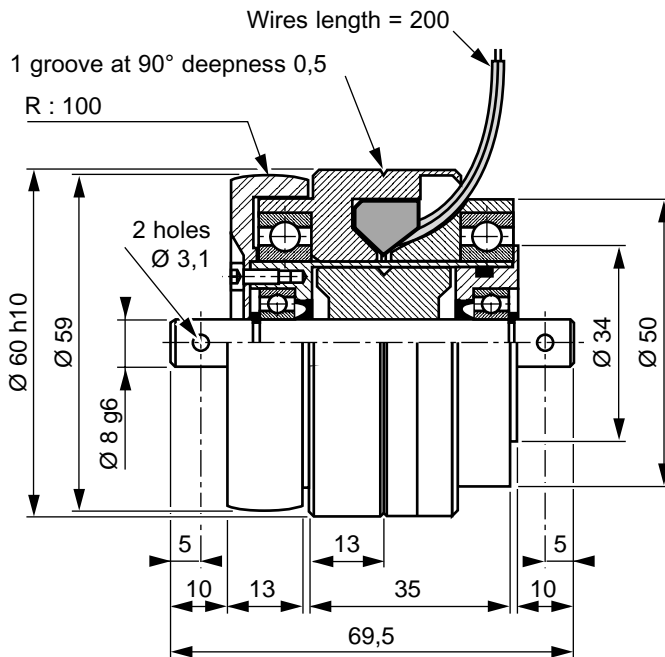
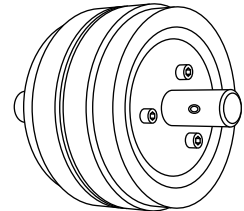

Utilization

- Mounting must be made without any stress.
Lubricated for life (other internal lubrication not allowed).
- Low DC current power supply for coil.
(See MEROBEL Electronic data sheets)
- The standard device is designed for horizontal shaft orientation, and a minimal speed of 60 RPM. Maximum speed is 3000 RPM (without exceeding the max. heat dissipation capability).
- For Engineering application, please contact our technical support.
- In normal use, the outside temperature of the device can increase up to 100°C, without damage.

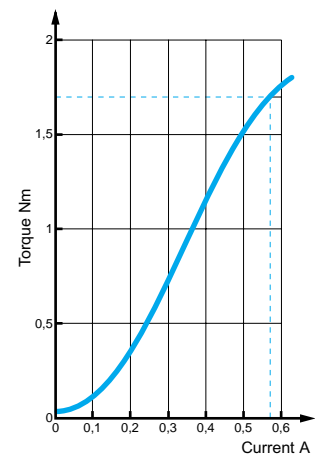

Safety

- If the device is to be used in dusty, humid or corrosive environment, special protection needs to be considered.

Maintenance

- Two procedures are available:

- Full inhouse maintenance servicing:

MEROBEL Inc. after sales
1705 Valley Road
Wanamassa, NJ 07712

Ph 732 493 3232

Fax 732 493 2949

- Spare parts or repair kits (depending on maintenance level):

- Assembled drum

ref: 806.540.03

- Assembling inductor

ref: 806.030.03

- External ball bearings (x2)

ref: 806.042.01

- Pulley washer play

ref: 807.097.01

- In any case, our After Sales service is at your disposal.

Recommended mounting principles

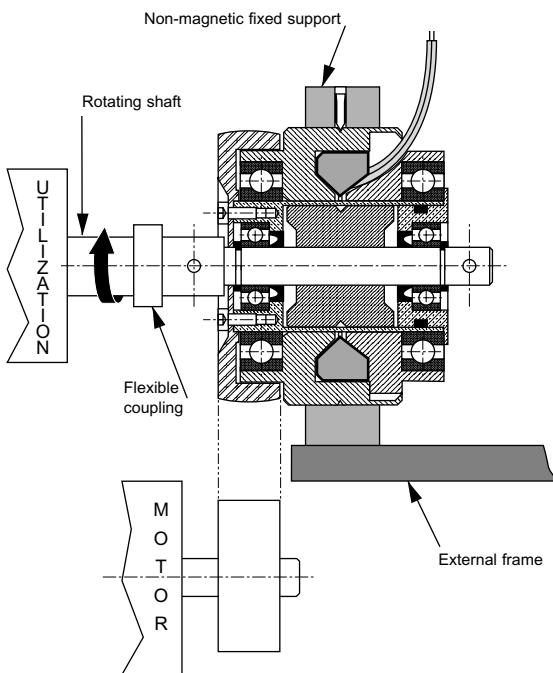

Washers are included for a play of 0.1 mm

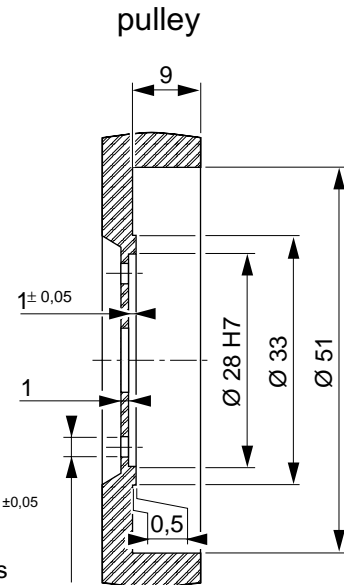

3 holes
Ø 2,7 at 120° on Ø 23 ±0,05
chamfer
0,2 at 45° on both sides