

# Clutch

EAT 650

ref : 322.300.00

## Specifications

Nominal torque	65	N.m	<i>ft.lbf</i>	<b>50</b>
Minimal torque	0.63	N.m	<i>ft.lbf</i>	<b>0.45</b>
Coil resistance - 20°C			<i>W</i>	<b>20</b>
Rated current DC			<b>A</b>	<b>1</b>
Rotor inertia	2.10 <sup>-3</sup>	kg.m <sup>2</sup>	<i>lb.ft<sup>2</sup></i>	<b>46 10<sup>-3</sup></b>
Weight	7.3	kg	<i>lb</i>	<b>16</b>
Heat dissipation continuous sustained depending on external part rotation speed	<i>W</i> *	<b>125</b>	<b>350</b>	<b>500</b>
	(RPM)	0	1000	2000

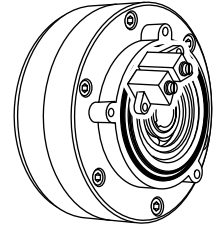

\* Heat dissipation is the mechanical power ( $P = cw$ ) maximum allowable.

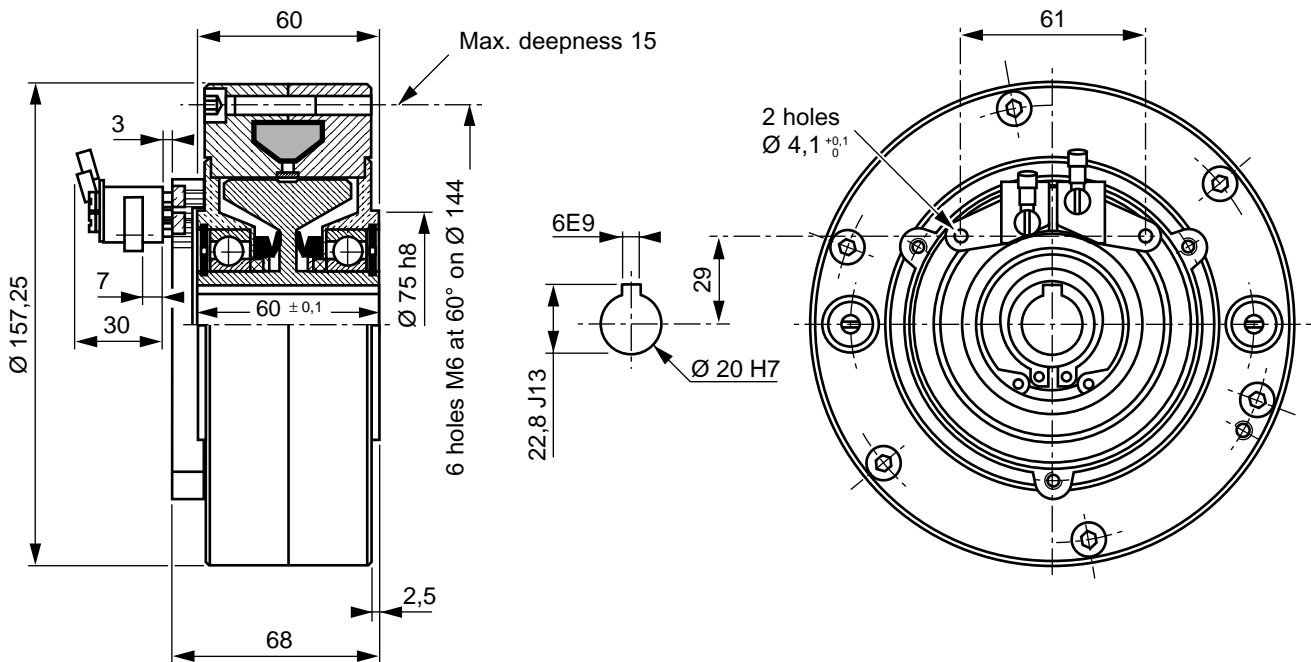

## Utilization

- Mounting must be made without any stress.  
Lubricated for life (other internal lubrication not allowed).  
The shaft should be lubricated upon assembly, to prevent seizing.
- Low DC current power supply for coil.  
(See MEROBEL Electronic data sheets )
- The standard device is designed for horizontal shaft orientation,  
and a minimal speed of 60 RPM. Maximum speed is 3000 RPM  
(without exceeding the max. heat dissipation capability).
- For Engineering application, please contact our technical support.
- In normal use, the outside temperature of the device can increase up to 100°C,  
without damage.

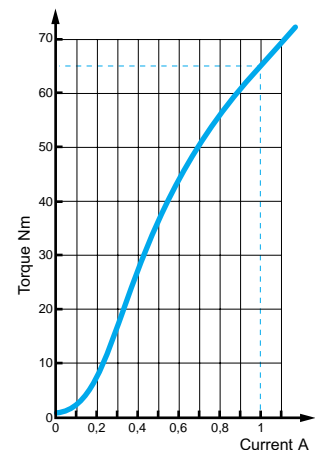

## Safety

- If the device is to be used in dusty, humid or corrosive environment, special protection needs to be considered.

## Maintenance

- Two procedures are available:

- Full inhouse maintenance servicing:

**MEROBEL Inc.** after sales  
1705 Valley Road  
Wanamassa, NJ 07712

Ph 732 493 3232

Fax 732 493 2949

- Spare parts or repair kits (depending on maintenance level):

- Kit (powder, ball bearings, seals, felts)	ref: 812.030.00
- Coil	ref: 322.100.07
- Rotor	ref: 315.500.03
- Collector	ref: 315.300.42
- Equipped brush holder	ref: 807.275.02
- 10 brushes set	ref: 807.079.01

- In any case, our After Sales service is at your disposal.

## Recommended mounting principles

**In line mounting**

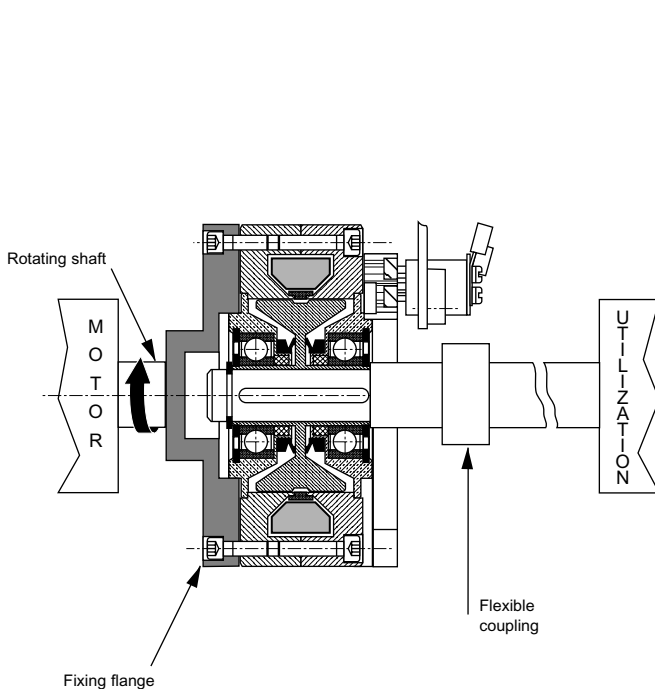

**Parallel mounting**

